



P-GATE

STR-SX-H900



The STERN Handicap Swing Gate is specifically designed to provide accessible passage for individuals with disabilities using wheelchairs or for the movement of materials. These gates are typically used in conjunction with Tripod Turnstiles or Speed Gates to create a comprehensive access control system.

The STR-SX-H900 is ergonomically and aesthetically designed for easy movement within access-controlled environments. The modular design allows for customization to suit specific application requirements.

The Stern prioritizes customer engagement and collaboration. The company actively works with customers to incorporate their ideas and supports architects in realizing their unique design visions through its comprehensive product offerings and solutions.

The Pedestrian Handicap Swing Gate features a combination of well-crafted stainless steel and faux glass panels, resulting in a design that is both visually appealing and durable.

The Swing gate offers an aisle width of 900mm for standard wheelchair access. For increased accessibility, two sets of gates can be deployed facing each other, creating a wider 1850mm passageway.

DIMENSIONS

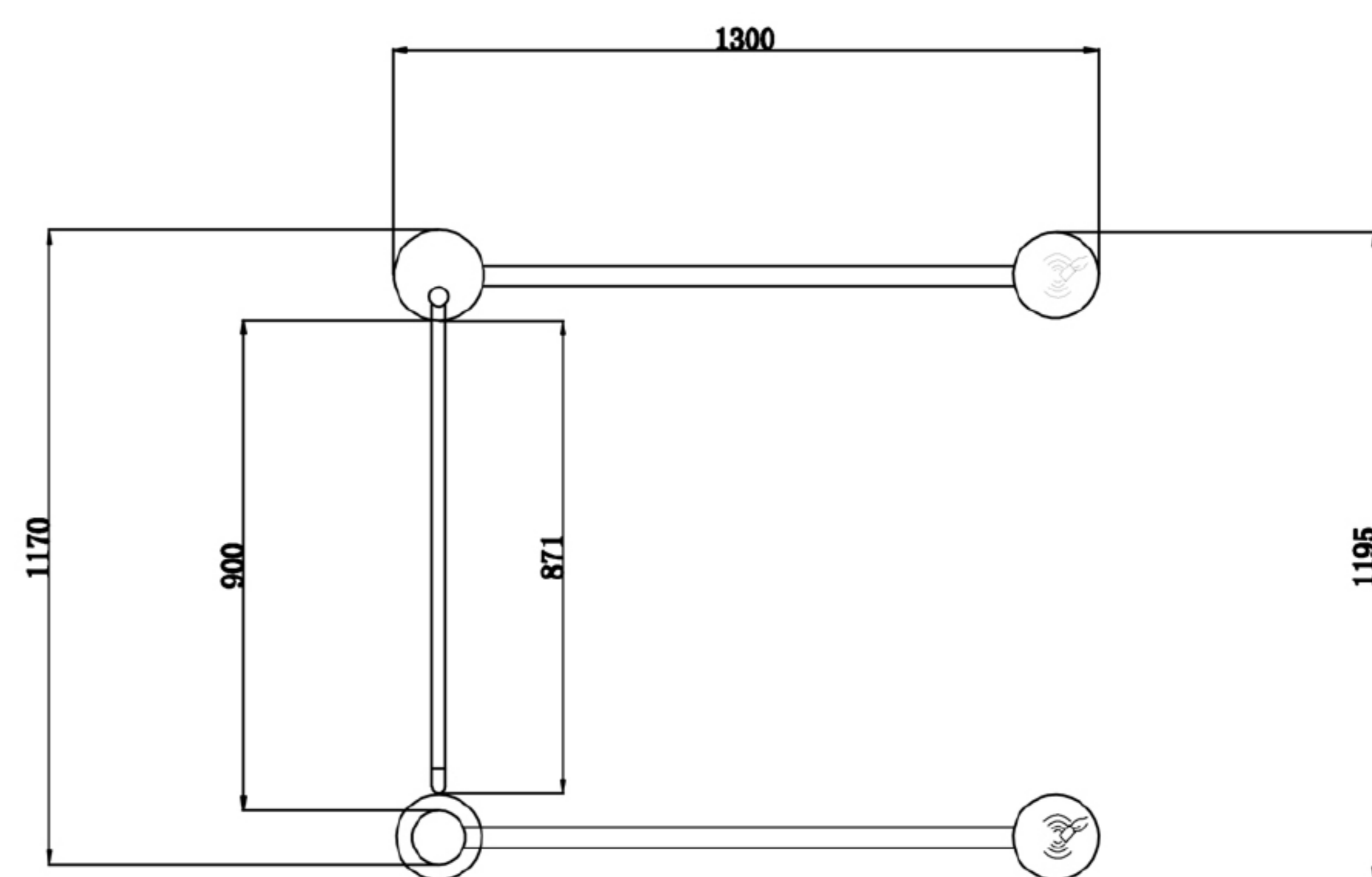
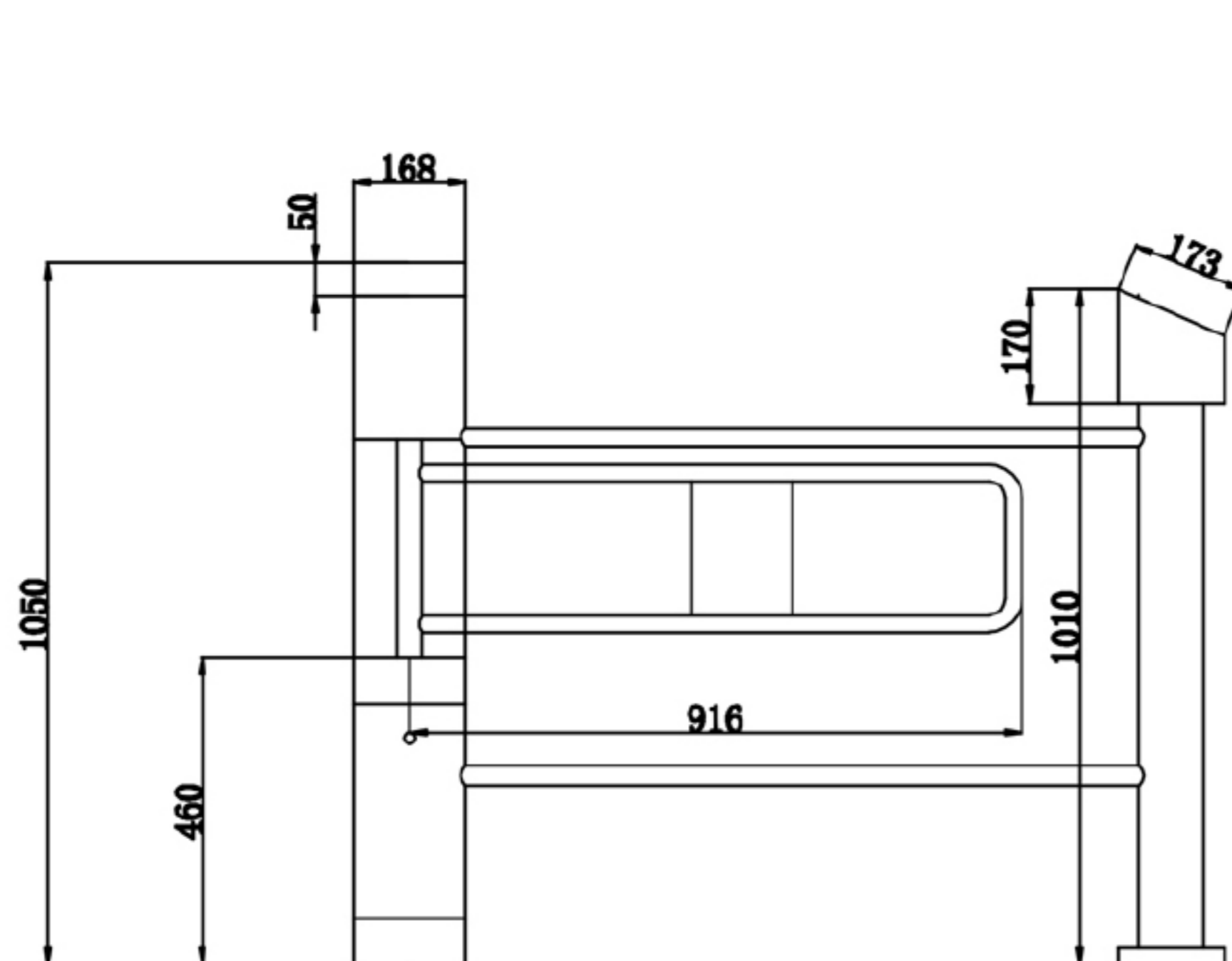

(All dimension are in mm)





P-GATE

STR-SX-H900

DESCRIPTION	PARTICULAR
Make	THE STERN
Model	STR-SX-H900
Material of Construction	304 Stainless steel
Housing Material Thickness	1.5mm
Housing Dimension (in mm)	168 Diameter X 1050 Height
Swing arm movement	180 Degrees
Operation	Bi-Directional
Opening & Closing Time	2-3 Seconds
Drive Motor	30W/24V
Power	AC 230V, ±10V, 50Hz
Power consumption	<50 W
Working Temperature	, -30C° to + 60°C
Relative Humidity	<95%, No Condensation
Throughput	20 Passages
Voltage	AC 220V, ±10V
IP Rating	IP43 (Outdoor, under canopy)
Hold Open Time	1S-60S adjustable, default is 5S
Emergency / Safety	Free passage when power off
Card Reader Interface	Potential Free Contact
Noice during operation	Less than 60db
Weight of the Product	42KG

